

# SHIMANO

## 1987 REPAIR MANUAL

Shimano American Corporation, One Shimano Dr.  
Irvine, CA 92718

### EXPLODED PARTS VIEW

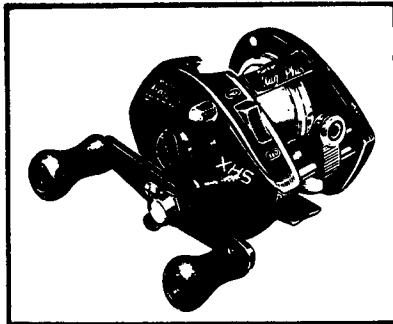
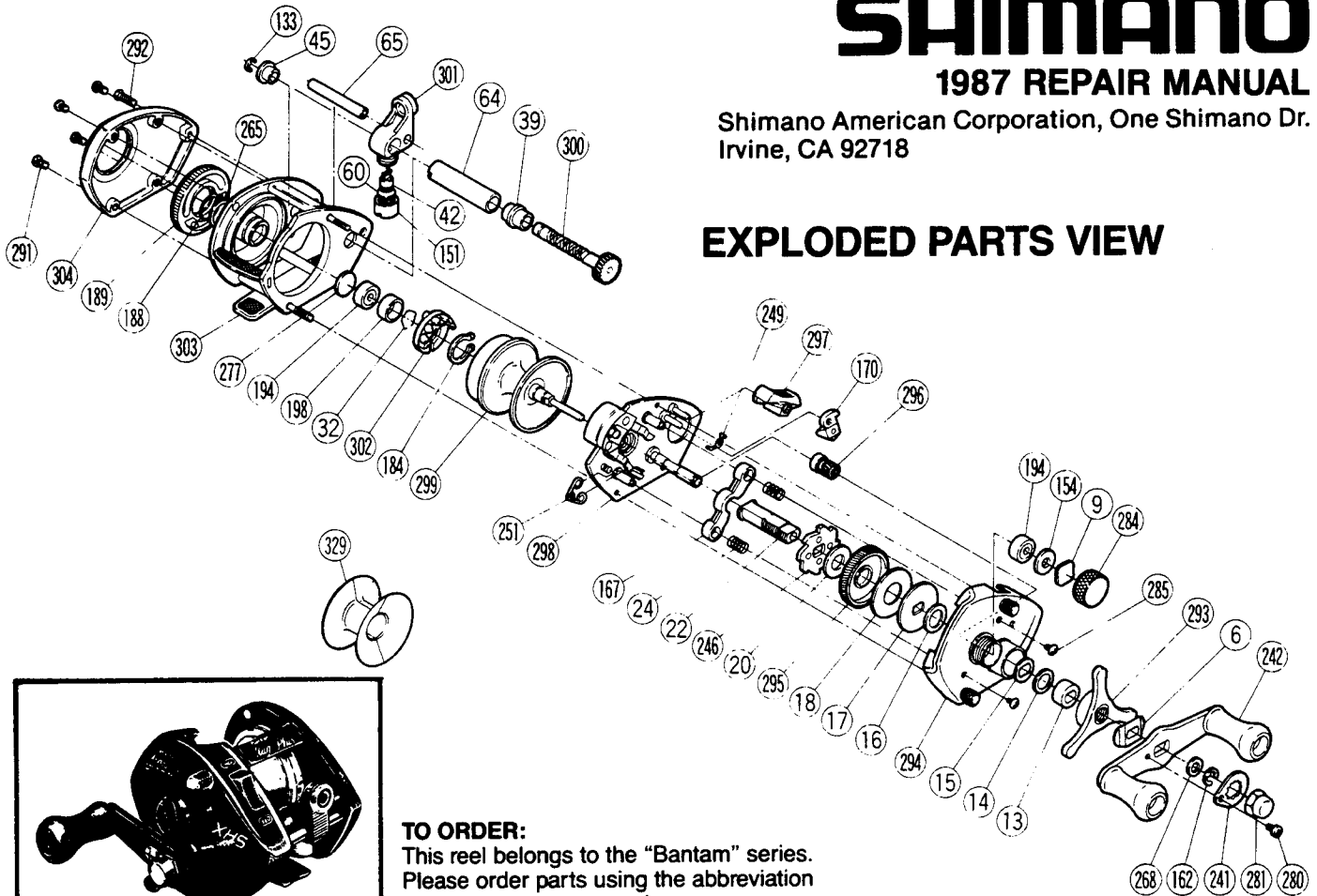

**TO ORDER:**  
This reel belongs to the "Bantam" series.  
Please order parts using the abbreviation  
"BNT" and the part number.

# BANTAM<sup>®</sup> MAG PLUS-<sup>™</sup> 350 SG

## PARTS LIST

### PART# DESCRIPTION

- 6. Friction Washer
- 9. Cast Control Spacer
- 13. Drive Shaft Bearing
- 14. Drag Spring Washer
- 15. "D" Washer
- 16. Drag Spacer
- 17. Pressure Plate
- 18. Drag Washer
- 20. Base Drag Washer
- 22. Drive Shaft
- 24. Pinion Yoke Spring
- 32. Bearing Lock
- 39. Level Wind Bearing Right
- 42. Level Wind Pawl
- 45. Level Wind Bearing Left
- 60. Pawl Shim (optional)
- 64. Level Wind Guard
- 65. Stabilizer Bar
- 133. Level Wind Gear Lock

### PART# DESCRIPTION

- 151. Pawl Cap
- 154. Felt Oil Retainer
- 162. "C" Lock
- 167. Pinion Yoke
- 170. Anti Reverse Dog
- 184. Magnet Retainer Lock
- 188. O Ring
- 189. Magnetic Control Dial
- 194. Spool Shaft Bearing
- 198. Bearing Spacer
- 241. Handle Nut Lock Plate
- 242. Handle
- 246. Anti Reverse Ratchet
- 249. Switch Spring
- 251. Retractor Spring
- 265. Thrust Washer
- 268. Drive Shaft Shim
- 277. Left Bearing Spacer
- 280. Handle Nut Lock Screw

### PART# DESCRIPTION

- 281. Handle Nut
- 284. Cast Control Cap
- 285. Right Side Plate Screw
- 291. Left Side Plate Screw
- 292. Left Stabilizer Bar Screw
- 293. Drag Tri-Star
- 294. Right Side Plate
- 295. Drive Gear
- 296. Pinion Gear
- 297. Anti Reverse Switch
- 298. Set Plate
- 299. Spool
- 300. Level Wind Gear
- 301. Line Guide
- 302. Magnet Retainer
- 303. Frame
- 304. Left Side Plate
- 329. V Spool Converter